

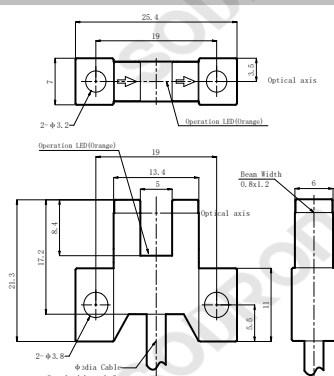

Dimensions



| Model | Technical parameters | |
|---|---|--|
| | Detection method | Through-beam |
| PU-K58 PU-K58P | Model | NPN PU-K58 PNP PU-K58P |
| | Output mode | Light-ON+Dark-ON |
| Product features <ul style="list-style-type: none"> • Through-beam type • Fast response and high frequency • IEC IP64 | Sensing distance | 5mm(slot width) |
| | Standard target | Opaque object of 1.2 × 0.8 mm or larger |
| | Light source | Infrared emission at 940 nm |
| | Differential | <0.05mm |
| | Repeat accuracy | <0.01mm |
| | Supply power | 5–24 V DC ±10% or less |
| | Residual voltage | 1 V or less (when the load current ≤ 50 mA) |
| | Current consumption | <15mA |
| | Load current | ≤50mA |
| | Circuit protection | Reverse polarity connection, Short circuit protection, overload protection |
| | Response frequency | ≥1kHz |
| | Indicator light | Action indicator light: Orange LED |
| | Connection | Cable 2m |
| Ambient temperature | Work: -25 ~ +55°C; Storage: -30 ~ +80°C, No dew condensation or icing allowed | |
| Ambient humidity | Work: 5 ~ 85%RH, Storage: 5 ~ 95%RH, (No dew condensation) | |
| Ambient illumination | Sunlight: 10,000Lx Lamplight: 3,000Lx | |
| Anti-vibration | 10~55Hz double-amplitude 1.5mmX,Y,Z 2h | |
| Withstand voltage | 1000VAC,50/60Hz 1min between current-carrying parts and case | |
| Insulation resistance | ≥ 20 MΩ (500 VDC, terminals to housings) | |
| Impact resistance | 500 m/s ² (X, Y, Z directions, 3 times) | |
| Protection degree | IEC IP64 | |
| Material | Housing | PBT |
| | Display cover | PC |

Connection

NPN

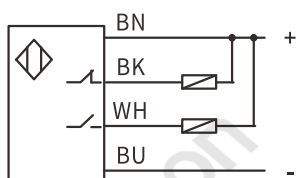

PNP

